

PERMIT
CITY OF NAPOLEON, OHIO — DEPT. OF BUILDING & ZONING
255 W. Riverview Avenue, Napoleon, Ohio 43545 (419) 592-4010

Permit No. 357 Date SEPT. 23, 1981
 Job Location 802 S. PERRY Valuation \$ 100.00
 Owner RICHARD G. HAYMAN Address 802 S. PERRY
Address Name
 Contractor OWNER Telephone No. 592-9415
 Address _____
 Electric Contractor _____
 Plumbing Contractor _____
 Mechanical Contractor _____

This permit is issued for work described in the plans, specifications, and/or application submitted, as approved by the Building Commissioner of the City of Napoleon, Ohio. Work shall conform to all pertinent construction and land use Codes and Ordinances.

Work Information:

Residential ONE Commercial _____ Industrial _____
No. dwelling units
 New Construction _____ Addition _____ Remodel _____
 Brief Description of Work STORAGE BUILDING 10 X 10

ISSUED BY Richard G. Hayman DEPT. OF BUILDING & ZONING
Building Official **PAID**

SEP 23 1981
 CITY OF NAPOLEON

It is the owners or contractors responsibility to call the Building Department for the following (X) inspections:

- Footing excavation prior to placing concrete.
- Footing drains and foundation prior to backfill.
- Prepared sub-grade prior to placing concrete floor slab.
- Sanitary sewer
- Rough-in electrical, plumbing and service framing prior to installing wall board.
- Final electrical, plumbing and heating.
- Final building inspection, prior to occupancy.

PERMIT & FEES	
Building Permit	\$ <u>3.00</u>
Electrical Permit	\$ _____
Plumbing Permit	\$ _____
Mechanical Permit	\$ _____
Demolition Permit	\$ _____
Zoning Permit	\$ _____
Sign Permit	\$ _____
Water Tap	\$ _____
Sewer Tap	\$ _____
Temp. Elec.	\$ _____
Other _____	\$ _____
TOTAL FEES	\$ <u>3.00</u>
LESS FEES PAID	\$ _____
BALANCE DUE	\$ <u>3.00</u>

Permit is not valid until all fees are paid in full, and shall be void if work is not started within six months of date above.

CITY OF NAPOLEON
 BUILDING INSPECTION DEPARTMENT
 APPLICATION FOR BUILDING PERMIT
 (Please print or type)

16 1/2 alley
 66 Roads
 60 S. PERRY

The undersigned hereby makes application for construction, installation, or alteration work as herein specified, agreeing to do all such work in strict accordance with the City of Napoleon's adopted Building Codes.

Location of project 802 S. PERRY Cost of project _____

Owner's Name RICHARD G. HAYMAN Address 802 S. PERRY

Contractor OWNER Telephone No. 592-9415

Address _____

Lot Information: (Not required for siding job)

Lot No. 60 N. HALE Subdivision SPRING WELLS ADDITION

Zoning District B Lot Size 82x5 ft. X 168 1/2 ft. Area _____ sq. ft.

Setbacks: Front 40 Right Side 5 Left Side 5 Rear 15

Work Information:

Residential _____ Commercial _____ Industrial _____

New Construction _____ Addition _____ Remodel _____

Accessory Building STORAGE Siding _____

(Specific Type)

Brief Description of Work: ----- 10X10 STORAGE BLDG.

Size: Length 10 Width 10 No. of Stories 1

Area: 1st Floor _____ sq. ft. Basement _____ sq. ft.

2nd Floor _____ sq. ft. Accessory Bldg. _____ sq. ft.

3rd Floor _____ sq. ft. Other _____ sq. ft.

Additional Information: _____

APPLICATION FOR PERMIT SHALL BE ACCOMPANIED BY TWO COMPLETE SETS OF PLANS INCLUDING: ELEVATIONS, FLOOR PLANS, CROSS SECTIONS AND PLOT PLAN. IF ADDITION OR REMODELING, SHOW ALL EXISTING STRUCTURES AND THEIR SIZE AND LOCATION. ALL PLANS SHALL BE DRAWN TO SCALE.

Date 9-23-81 Applicant's Signature Richard G. Hayman

PERMIT NO. 357

PERMIT FEE \$ 3.00

86
 16 1/2

S. PERRY

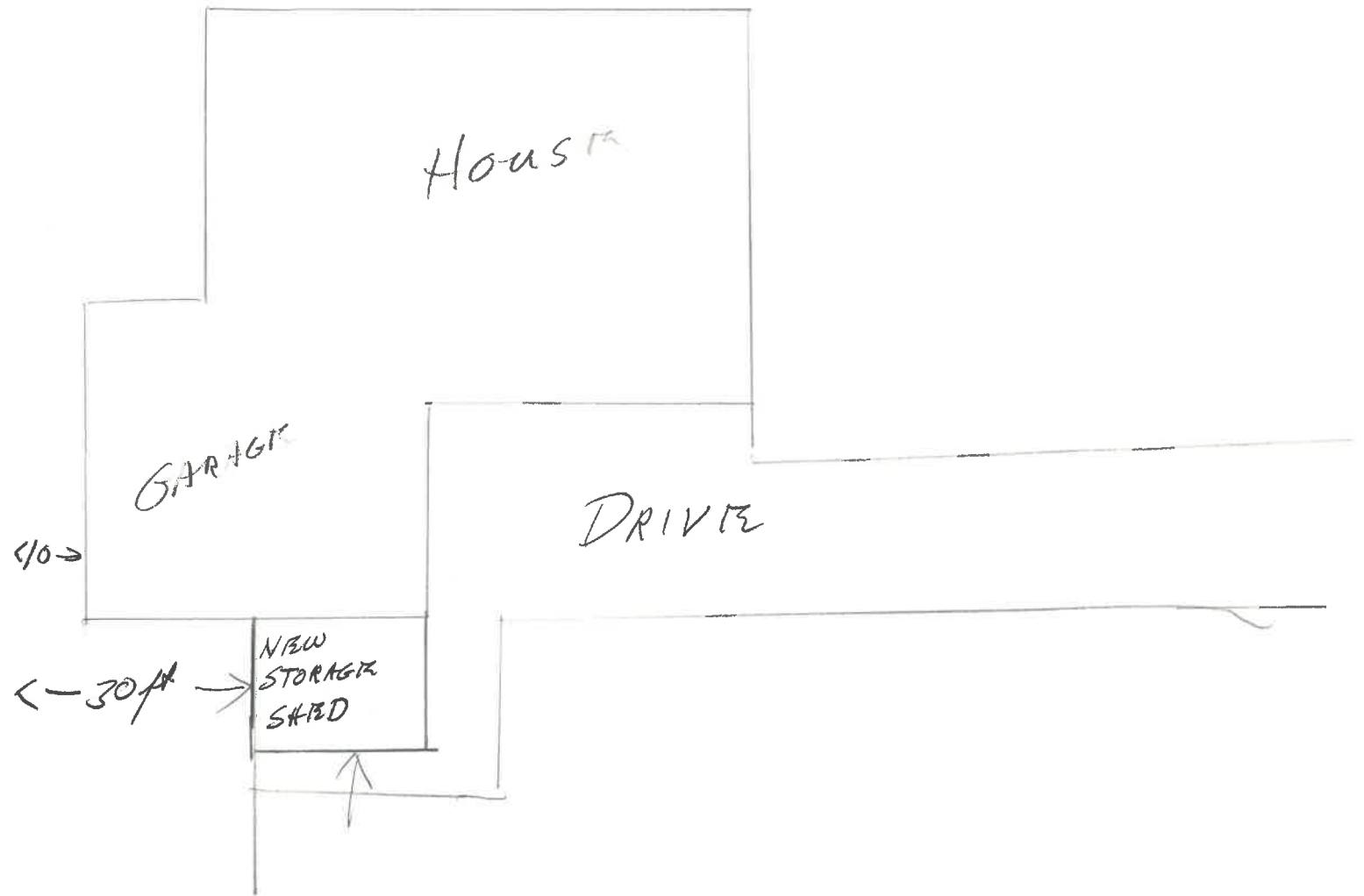

PERMIT

CITY OF NAPOLEON, OHIO — DEPT. OF BUILDING & ZONING
255 W. Riverview Avenue, Napoleon, Ohio 43545 (419) 592-4010

Permit No. 357
Job Location 802 S. PERRY Address Valuation \$ 100.00
Owner RICHARD G. HAYMAN Address 802 S. PERRY
Contractor OWNER Name Telephone No. 592-9415
Address _____
Electric Contractor _____
Plumbing Contractor _____
Mechanical Contractor _____

This permit is issued for work described in the plans, specifications, and/or application submitted, as approved by the Building Commissioner of the City of Napoleon, Ohio. Work shall conform to all pertinent construction and land use Codes and Ordinances.

Work Information:

Residential ONE No. dwelling units Commercial _____ Industrial _____
New Construction _____ Addition _____ Remodel _____
Brief Description of Work STORAGE BUILDING 10 X 10

ISSUED BY _____ Building Official DEPT. OF BUILDING & ZONING

PAID
SEP 23 1981
CITY OF NAPOLEON

It is the owners or contractors responsibility to call the Building Department for the following (x) inspections:

- _____ Footing excavation prior to placing concrete.
- _____ Footing drains and foundation prior to backfill.
- _____ Prepared sub-grade prior to placing concrete floor slab.
- _____ Sanitary sewer
- _____ Rough-in electrical, plumbing and service framing prior to installing wall board.
- _____ Final electrical, plumbing and heating.
- Final building inspection, prior to occupancy.

PERMIT & FEES

Building Permit	\$ <u>3.00</u>
Electrical Permit	\$ _____
Plumbing Permit	\$ _____
Mechanical Permit	\$ _____
Demolition Permit	\$ _____
Zoning Permit	\$ _____
Sign Permit	\$ _____
Water Tap	\$ _____
Sewer Tap	\$ _____
Temp. Elec.	\$ _____
Other _____	\$ _____
TOTAL FEES	\$ <u>3.00</u>
LESS FEES PAID	\$ _____
BALANCE DUE	\$ <u>3.00</u>

Permit is not valid until all fees are paid in full, and shall be void if work is not started within six months of date above.

INSPECTION RECORD

UNDERGROUND		ROUGH-IN & FINAL			
Type	Date	By	Type	Date	By
PLUMBING	Sewer Connection		Drainage, W. & Vent		
	Building Sewer		Water Piping		
	Water Piping		Condensate Lines		
			Indirect Waste		
				FINAL APPROVAL	
ELECTRICAL	Floor Ducts Raceways		Rough Wiring		Electric Mtr. Clearance
	Conduits & or Cable		Conduits/ Cable		Signs
	Grounding & or Bonding		Service Panel Switchboard		
			Subpanels		
			<input type="checkbox"/> Range <input type="checkbox"/> Dryer		FINAL APPROVAL
MECHANICAL	Refrigerant Piping		Refrigerant Piping		Duct Insulation
	Ducts/ Plenums		Ducts/ Plenums		Chimney(s)
			Ventilation Supply		Furnace(s)
			<input type="checkbox"/> Exhst.		FINAL APPROVAL
			Wall Construction		Fireplace Chimney
BUILDING	Excavation		Crawl Space <input type="checkbox"/> Vent <input type="checkbox"/> Access		Attic <input type="checkbox"/> Vent <input type="checkbox"/> Access
	Footings & Reinforcing		Floor System(s)		Special Insp Reports Rec'd
	Sub-soil Drain		Roof System		Smoke Detector
	Foundation Walls		Fire Wall(s)		Demolition (sewer cap)
	Floor Slab		Roof Cover Roof Drain		Building or Structure
	FINAL APPROVAL BLDG. DEPT		Certificate of Occupancy Issued		#

JRC-10-29-21